

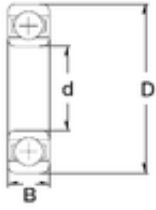

# PCIF BEARING LIMITED



9,525 mm x 23,018 mm x 7,937 mm ZEN  
S1606-2RS deep groove ball bearings

Bearing No. S1606-2RS

Size	9.525x23.018x7.937 mm
Bore Diameter	9,525 mm
Outer Diameter	23,018 mm
Width	7,937 mm
d	9,525 mm
D	23,018 mm
B	7,937 mm
C	7,937 mm
Weight	0,021 Kg
Basic dynamic load rating (C)	2,065 kN

S1606-2RS Bearing 2D drawings and 3D CAD models