

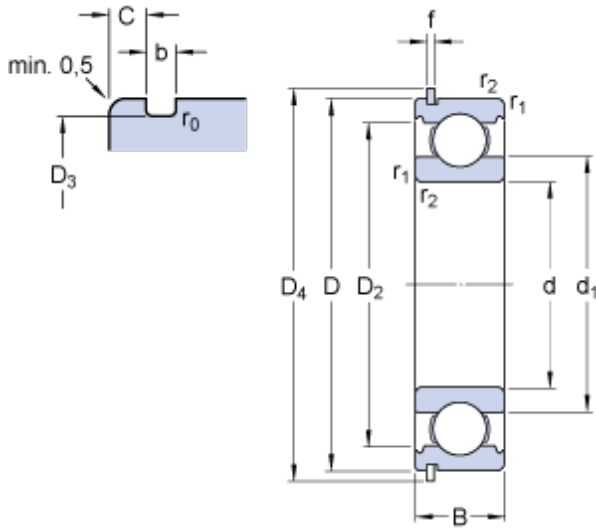

PCIF BEARING LIMITED



30 mm x 62 mm x 16 mm skf 6206 nr bearing

Bearing No. 6206 nr

Size	62x30x16 mm
Bore Diameter	62 mm
Outer Diameter	30 mm
Width	16 mm
d	30 mm
D	62 mm
B	16 mm
d ₁	40.36 mm
D ₂	54.06 mm
D ₃	59.61 mm
D ₄	67.7 mm
b	1.9 mm
C	3.28 mm
f	1.7 mm
r ₀	0.6 mm
r _{1,2} - min.	1 mm
d _a - min.	35.6 mm
D _a - max.	56.4 mm
D _b - min.	69 mm
b _a - min.	2.2 mm
C _a - max.	4.98 mm
r _a - max.	1 mm
Basic dynamic load rating - C	20.3 kN
Basic static load rating - C ₀	11.2 kN
Fatigue load limit - P _u	0.475 kN

6206 nr Bearing 2D drawings and 3D CAD models



PCIF BEARING LIMITED

Reference speed	24000 r/min
Limiting speed	15000 r/min
Calculation factor - k_r	0.025
Calculation factor - f_0	13.8
Mass bearing	0.205 kg
Category	Single Row Ball Bearings
Inventory	0.0
Manufacturer Name	SKF
Minimum Buy Quantity	N/A
Weight / Kilogram	0.21
EAN	7316577741073
Product Group	B00308
Enclosure	Open
Precision Class	ABEC 1 ISO P0
Maximum Capacity / Filling Slot	No
Rolling Element	Ball Bearing
Snap Ring	Yes
Internal Special Features	No
Cage Material	Steel
Internal Clearance	C0-Medium
Inch - Metric	Metric
Long Description	30MM Bore; 62MM Outside Diameter; 16MM Outer Race Width; Open; Ball Bearing; ABEC 1 ISO P0; No Filling Slot; Yes Snap Ring; No Internal Special Features; C0-Medium Internal Clearance; Steel Cage
Other Features	Deep Groove With Snap Ring
Category	Single Row Ball Bearing
UNSPSC	31171504



PCIF BEARING LIMITED

Harmonized Tariff Code	8482.10.50.68
Noun	Bearing
Keyword String	Ball
Manufacturer URL	http://www.skf.com
Manufacturer Item Number	6206 NR
Weight / LBS	0.439
Outer Race Width	0.63 Inch 16 Millimeter
Inner Race Width	0 Inch 0 Millimeter
Outside Diameter	2.441 Inch 62 Millimeter
Bore	1.181 Inch 30 Millimeter
d_1	40.36 mm
D_2	54.06 mm
D_3	59.61 mm
D_4	67.7 mm
r_0 max.	0.6 mm
$r_{1,2}$ min.	1 mm
d_a min.	35.6 mm
D_a max.	56.4 mm
D_b min.	69 mm
b_a min.	2.2 mm
C_a max.	4.98 mm
r_a max.	1 mm
Basic dynamic load rating C	20.3 kN
Basic static load rating C_0	11.2 kN
Fatigue load limit P_u	0.475 kN
Calculation factor k_r	0.025
Calculation factor f_0	13.8
Snap ring	SP 62