

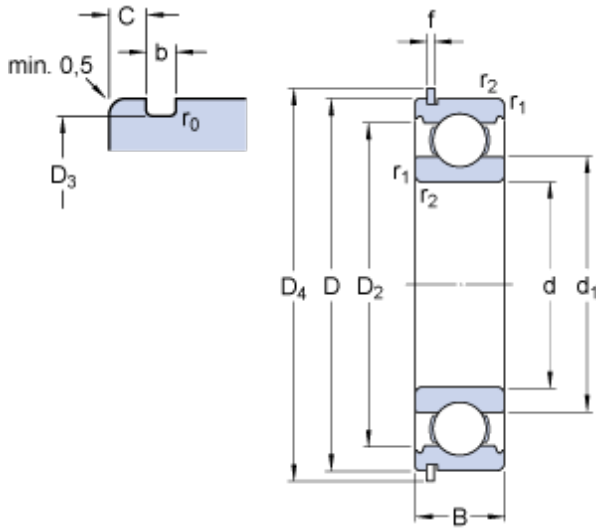

# PCIF BEARING LIMITED



## 25 mm x 52 mm x 15 mm skf 6205 nr bearing

Bearing No. 6205 nr

Size	52x25x15 mm
Bore Diameter	52 mm
Outer Diameter	25 mm
Width	15 mm
d	25 mm
D	52 mm
B	15 mm
d <sub>1</sub>	34.35 mm
D <sub>2</sub>	46.21 mm
D <sub>3</sub>	49.73 mm
D <sub>4</sub>	57.9 mm
b	1.35 mm
C	2.46 mm
f	1.12 mm
r <sub>0</sub>	0.4 mm
r <sub>1,2</sub> - min.	1 mm
d <sub>a</sub> - min.	30.6 mm
D <sub>a</sub> - max.	46.4 mm
D <sub>b</sub> - min.	59 mm
b <sub>a</sub> - min.	1.5 mm
C <sub>a</sub> - max.	3.58 mm
r <sub>a</sub> - max.	1 mm
Basic dynamic load rating - C	14.8 kN
Basic static load rating - C <sub>0</sub>	7.8 kN
Fatigue load limit - P <sub>u</sub>	0.335 kN

6205 nr Bearing 2D drawings and 3D CAD models



## PCIF BEARING LIMITED

Reference speed	28000 r/min
Limiting speed	18000 r/min
Calculation factor - $k_r$	0.025
Calculation factor - $f_0$	14
Mass bearing	0.13 kg
Category	Single Row Ball Bearings
Inventory	0.0
Manufacturer Name	SKF
Minimum Buy Quantity	N/A
Weight / Kilogram	0.137
EAN	7316577096616
Product Group	B00308
Enclosure	Open
Precision Class	ABEC 1   ISO P0
Maximum Capacity / Filling Slot	No
Rolling Element	Ball Bearing
Snap Ring	Yes
Internal Special Features	No
Cage Material	Steel
Internal Clearance	C0-Medium
Inch - Metric	Metric
Long Description	25MM Bore; 52MM Outside Diameter; 15MM Outer Race Width; Open; Ball Bearing; ABEC 1   ISO P0; No Filling Slot; Yes Snap Ring; No Internal Special Features; C0-Medium Internal Clearance; Steel Cage
Other Features	Deep Groove   With Snap Ring
Category	Single Row Ball Bearing
UNSPSC	31171504



## PCIF BEARING LIMITED

Harmonized Tariff Code	8482.10.50.68
Noun	Bearing
Keyword String	Ball
Manufacturer URL	<a href="http://www.skf.com">http://www.skf.com</a>
Manufacturer Item Number	6205 NR
Weight / LBS	0.302
Bore	0.984 Inch   25 Millimeter
Outer Race Width	0.591 Inch   15 Millimeter
Inner Race Width	0 Inch   0 Millimeter
Outside Diameter	2.047 Inch   52 Millimeter
$d_1$	34.35 mm
$D_2$	46.21 mm
$D_3$	49.73 mm
$D_4$	57.9 mm
$r_0$ max.	0.4 mm
$d_a$ min.	30.6 mm
$D_a$ max.	46.4 mm
$D_b$ min.	59 mm
$b_a$ min.	1.5 mm
$C_a$ max.	3.58 mm
$r_a$ max.	1 mm
Basic dynamic load rating C	14.8 kN
Basic static load rating $C_0$	7.8 kN
Fatigue load limit $P_u$	0.335 kN
Calculation factor $k_r$	0.025
Calculation factor $f_0$	14
Snap ring	SP 52