

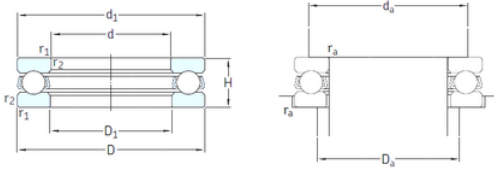

PCIF BEARING LIMITED



skf 51112 bearing

Bearing No. 51112

Size	60x85x17 mm
Bore Diameter	60 mm
Outer Diameter	85 mm
Width	17 mm
d	60 mm
D	85 mm
H	17 mm
d1	85 mm
r1 min.	1 mm
r2 min.	1 mm
D1	62 mm
da min.	75 mm
Da max.	70 mm
ra max.	1 mm
Weight	0,27 Kg
Basic dynamic load rating (C)	41,6 kN
Basic static load rating (C0)	122 kN
Fatigue load limit (Pu)	4,55
Reference speed	3600 r/min
Limiting speed	5000 r/min
Category	Thrust Ball Bearing
Inventory	0.0
Manufacturer Name	SKF
Minimum Buy Quantity	N/A
Weight / Kilogram	0.309
EAN	7316576677489

51112 Bearing 2D drawings and 3D CAD models



PCIF BEARING LIMITED

Product Group	B00308
Rolling Element	Ball Bearing
Thrust Bearing	Yes
Single or Double Direction	Single Direction
Banded	No
Cage Material	Steel
Precision Class	ABEC 1 ISO P0
Component Description	Roller Assembly Plus Raceways
Other Features	Single Row
Long Description	60MM Bore 1; 62MM Bore 2; 85MM Outside Diameter; 17MM Height; Ball Bearing; Single Direction; Not Banded; Steel Cage; ABEC 1 ISO P0 Precision
Inch - Metric	Metric
Category	Thrust Ball Bearings
UNSPSC	31171507
Harmonized Tariff Code	8482.10.50.08
Noun	Bearing
Keyword String	Ball Thrust
Manufacturer URL	http://www.skf.com
Manufacturer Item Number	51112
Weight / LBS	0.68
Outside Diameter	3.346 Inch 85 Millimeter
Bore 2	2.441 Inch 62 Millimeter
Bore 1	2.362 Inch 60 Millimeter
Height	0.669 Inch 17 Millimeter
Overall Height with Aligning Washer	0 Inch 0 Millimeter
bore diameter:	60 mm
static load capacity:	122 kN
outside diameter:	85 mm



PCIF BEARING LIMITED

dynamic load capacity:	41.6 kN
overall width:	17 mm
maximum rpm:	5000 RPM
thrust bearing type:	Single-Direction
cage material:	Steel
outside diameter design:	Straight
fillet radius:	1 mm
separable or banded:	Separable
series:	511
precision rating:	ABEC 1 (ISO Class Normal)
d_1	85 mm
D_1	62 mm
$r_{1,2}$ min.	1 mm
d_a min.	75 mm
D_a max.	70 mm
r_a max.	1 mm
Basic dynamic load rating C	41.6 kN
Basic static load rating C_0	122 kN
Fatigue load limit P_u	4.55 kN
Minimum load factor A	0.077
Mass bearing (including seat washer where applicable)	0.27 kg