

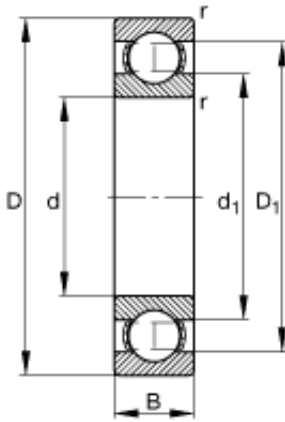

PCIF BEARING LIMITED

45 mm x 85 mm x 19 mm fag 6209 bearing

Bearing No. 6209



6209 Bearing 2D drawings and 3D CAD models

Size	45x85x19 mm
Bore Diameter	45 mm
Outer Diameter	85 mm
Width	19 mm
d	45 mm
D	85 mm
B	19 mm
D ₁	71,8 mm
D _{a max}	78 mm
d ₁	57,2 mm
d _{a min}	52 mm
r _{a max}	1 mm
r _{min}	1,1 mm
m	0,429 kg / Weight
C _r	33000 N / Dynamic load rating (radial)
C _{0r}	20300 N / Static load rating (radial)
n _G	11600 1/min / Limiting speed
n _B	8700 1/min / Reference speed
C _{ur}	1030 N / Fatigue limit load, radial