

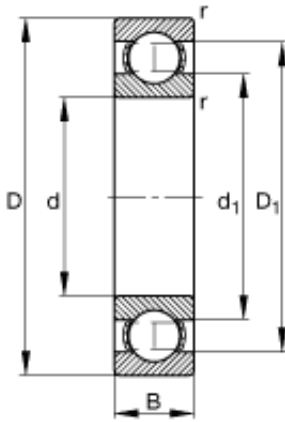

PCIF BEARING LIMITED



40 mm x 90 mm x 23 mm fag 6308 bearing

Bearing No. 6308

6308 Bearing 2D drawings and 3D CAD models

Size	40x90x23 mm
Bore Diameter	40 mm
Outer Diameter	90 mm
Width	23 mm
d	40 mm
D	90 mm
B	23 mm
D ₁	74,6 mm
D _{a max}	81 mm
d ₁	55,6 mm
d _{a min}	49 mm
r _{a max}	1,5 mm
r _{min}	1,5 mm
m	0,64 kg / Weight
C _r	45500 N / Dynamic load rating (radial)
C _{0r}	25000 N / Static load rating (radial)
n _G	10800 1/min / Limiting speed
n _B	9000 1/min / Reference speed
C _{ur}	1270 N / Fatigue limit load, radial