

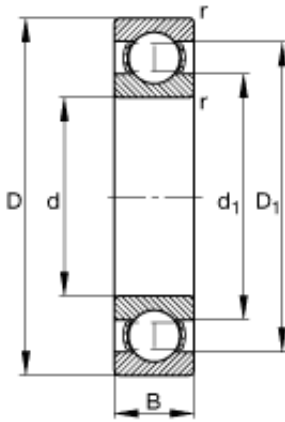

PCIF BEARING LIMITED

40 mm x 80 mm x 18 mm fag 6208 bearing

Bearing No. 6208



6208 Bearing 2D drawings and 3D CAD models

Size	40x80x18 mm
Bore Diameter	40 mm
Outer Diameter	80 mm
Width	18 mm
d	40 mm
D	80 mm
B	18 mm
D ₁	67,5 mm
D _{a max}	73 mm
d ₁	53 mm
d _{a min}	47 mm
r _{a max}	1 mm
r _{min}	1,1 mm
m	0,372 kg / Weight
C _r	31000 N / Dynamic load rating (radial)
C _{0r}	17800 N / Static load rating (radial)
n _G	12300 1/min / Limiting speed
n _B	9300 1/min / Reference speed
C _{ur}	900 N / Fatigue limit load, radial