

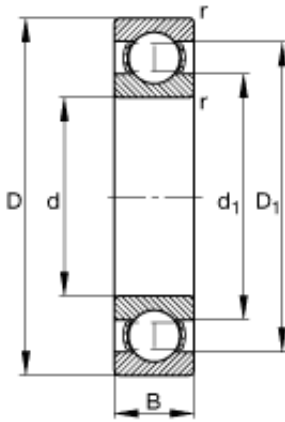

PCIF BEARING LIMITED

35 mm x 72 mm x 17 mm fag 6207 bearing

Bearing No. 6207



6207 Bearing 2D drawings and 3D CAD models

Size	35x72x17 mm
Bore Diameter	35 mm
Outer Diameter	72 mm
Width	17 mm
d	35 mm
D	72 mm
B	17 mm
D ₁	60,7 mm
D _{a max}	65 mm
d ₁	47,2 mm
d _{a min}	42 mm
r _{a max}	1 mm
r _{min}	1,1 mm
m	0,291 kg / Weight
C _r	27500 N / Dynamic load rating (radial)
C _{0r}	15300 N / Static load rating (radial)
n _G	13800 1/min / Limiting speed
n _B	10300 1/min / Reference speed
C _{ur}	770 N / Fatigue limit load, radial