

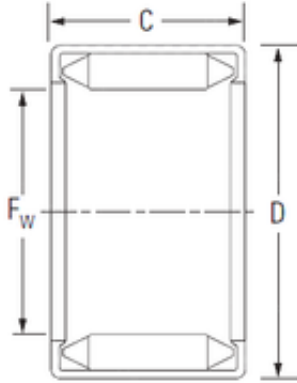

# PCIF BEARING LIMITED

## koyo 18bm2416 bearing



Bearing No. 18bm2416

Size	18x24x16 mm
Bore Diameter	18 mm
Outer Diameter	24 mm
Width	16 mm
Fw	18 mm
D	24 mm
C	16 mm
Weight	0,018 Kg
Basic dynamic load rating (C)	16,5 kN
Basic static load rating (C0)	29,1 kN

18bm2416 Bearing 2D drawings and 3D CAD models