

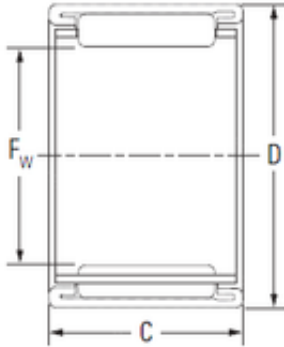

# PCIF BEARING LIMITED

## koyo btm141912a bearing



Bearing No. btm141912a

Size	13.5x19x12 mm
Bore Diameter	13,5 mm
Outer Diameter	19 mm
Width	12 mm
Fw	13,5 mm
D	19 mm
C	12 mm
Weight	0,0095 Kg
Basic dynamic load rating (C)	6,25 kN
Basic static load rating (C0)	7,95 kN
(Grease) Lubrication Speed	14000 r/min

btm141912a Bearing 2D drawings and 3D CAD models